

PLAN OF CREATION OF EASEMENT

EDITION 1

LOCATION OF LAND

PARISH: STRATHFIELDSAYE

TOWNSHIP: -

SECTION: -

CROWN ALLOTMENT: 18 (PART)

CROWN PORTION: -

TITLE REFERENCE: C/T VOL 11609 FOL 497

LAST PLAN REFERENCE: LOT 13 ON PS726691V

POSTAL ADDRESS: 58 LANARK DRIVE,
(at time of subdivision) JUNORTOUN 3551

MGA CO-ORDINATES: E: 262 540 ZONE: 55
(of approx centre of land in plan) N: 5 926 280

I, Michael Meehan of 16 Bridge Street, Bendigo 3550 certify that this plan correctly represents the information obtained by me from the sources indicated on this plan.

Date: 11/05/2016

Licensed Surveyor,
Surveyors Act 2004

EASEMENT INFORMATION

Notations

LEGEND: A - Appurtenant Easement E - Encumbering Easement R - Encumbering Easement (Road)

Depth limitations: Does not apply

Easement Reference	Purpose	Width (Metres)	Origin	Land Benefited/In Favour of
E-1	DRAINAGE	2	THIS PLAN	CITY OF GREATER BENDIGO

Purpose of this plan:
To create easement E-1

Grounds for easement creation:
By agreement under Sec 72 of the
Transfer of Land Act 1958

Survey: This plan is not based on survey.
This survey has been connected to permanent
marks No(s).
In Proclaimed Survey Area No.

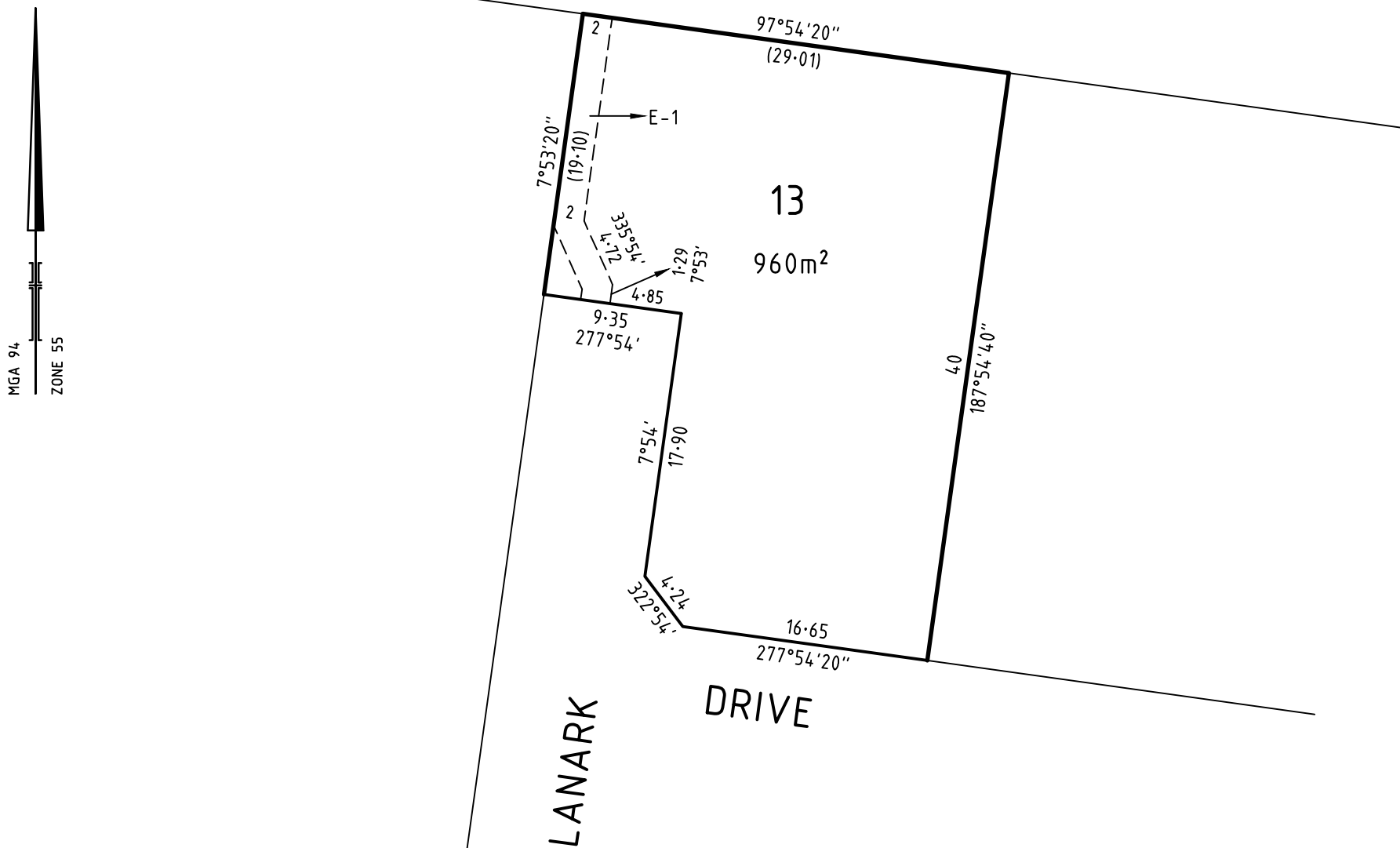

spiire

16 Bridge Street
PO Box 1064
Bendigo Vic 3550
T 61 3 5448 2500
spiire.com.au

SCALE
1: 400

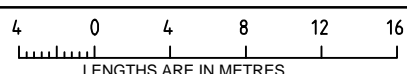

ORIGINAL SHEET
SIZE: A3

SHEET 1 OF 1

Licensed Surveyor: Michael Meehan
Ref: 300447SV02
Version: 1